



MATRIX **Wall** **Player**

**CONECTANDO À TELEVISÃO
LINE - AUX**

Conexão em saída de áudio analógico do televisor

Utilizando Cabo Philips 2 vias + Conector P2

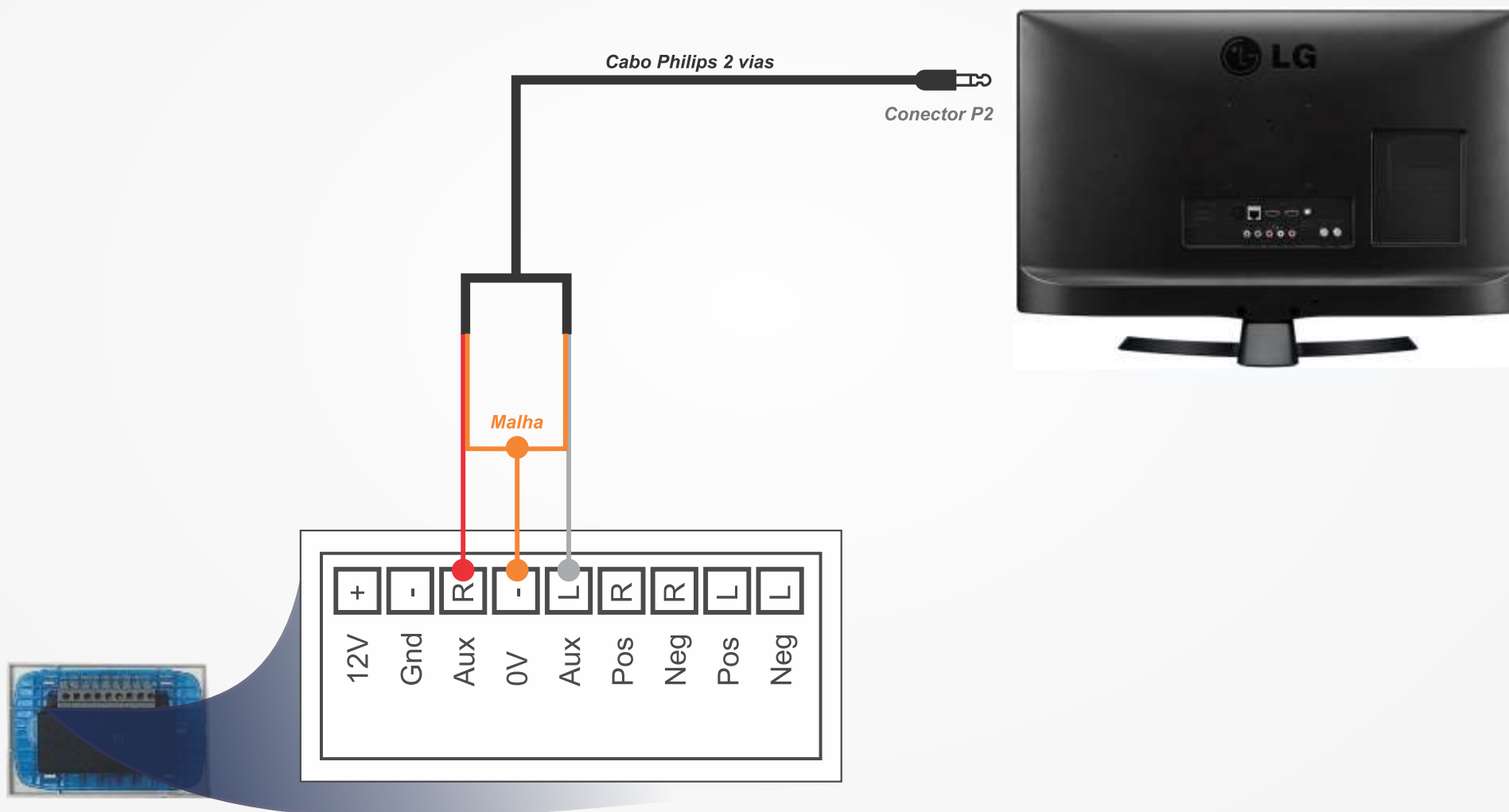

Conexão em saída de áudio óptico do televisor

Utilizando Cabo Philips 2 vias + Conectores RCA + Saída Óptica

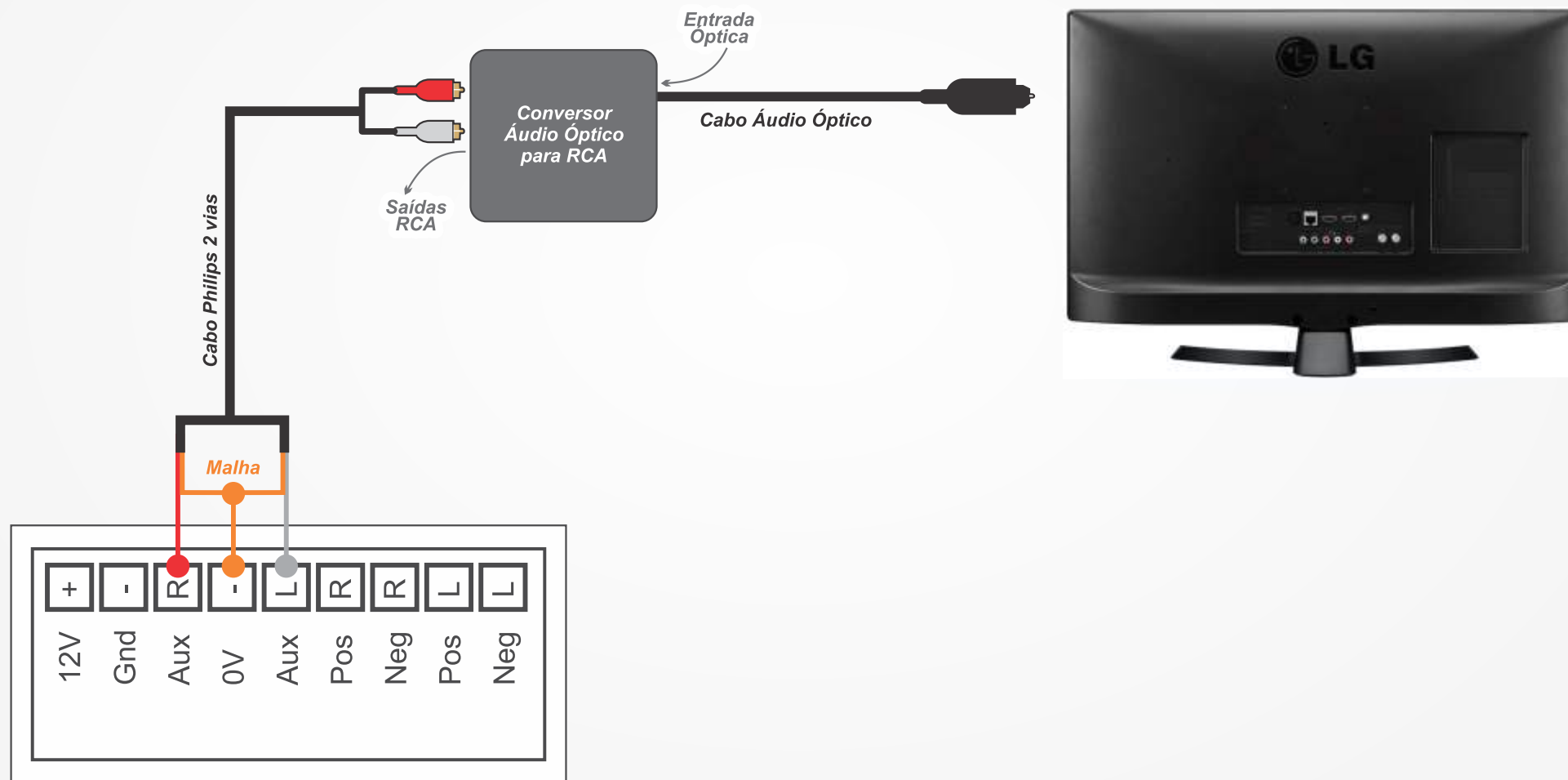



MATRIX
— CONTROL —

www.matrixcontrol.com.br

 matrix_control

 sistemamatrixcontrol

 matrixcontrol